



VERTICAL EXPRESS

Phone: 866.448.3789

www.verticalxpress.com

Oil Buffers

Vertical Express Oil Buffers are designed and manufactured of heavy-duty construction for speeds from 200 fpm to 1000 fpm, as well as 1200 fpm with ETSL [Emergency Terminal Speed Limiting]. There may be a number of reasons that your elevators may require an upgrade to oil buffers, including:

- Increased capacity because your elevators have been modernized.
- Speed of your elevators has increased because of modernization.
- Damage to existing equipment due to moisture conditions.

Our Oil Buffers are built according to strict engineering standards and conform to ASME A17.1 and Canadian B44 safety codes. These reliable Oil Buffers have a quick turn-around time and are easy to install.

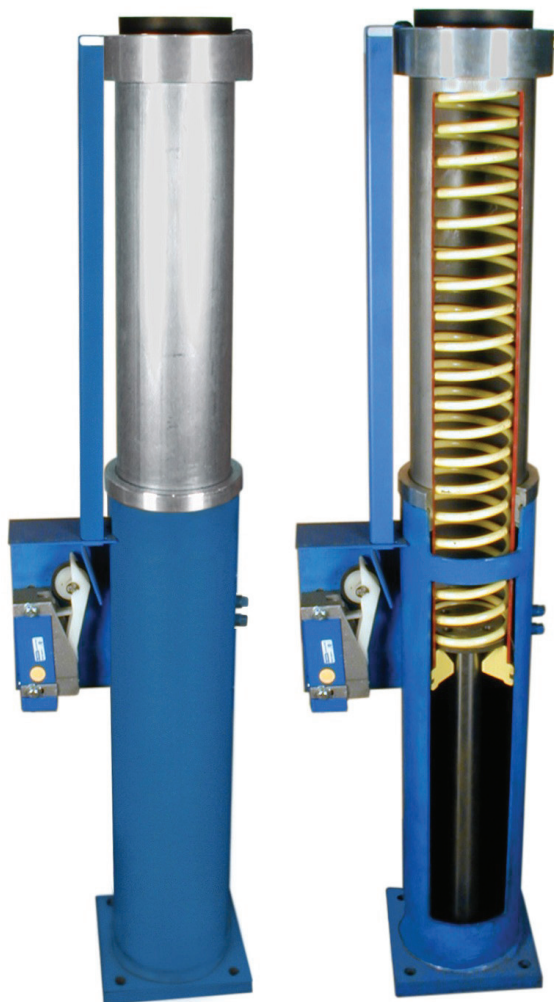

External View
of Buffer

Internal View
of Buffer

Vertical Express
9280 Crestwyn Hills
Memphis, TN 38125
All illustrations and
specifications are based on
information in effect at time of
publication approval. Vertical
Express reserves the right to
change specifications or
design and to discontinue
items without prior notice or
obligation.

© 2016 Vertical Express

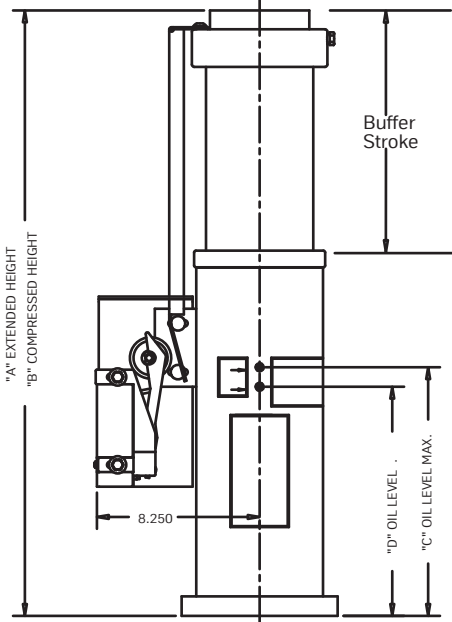
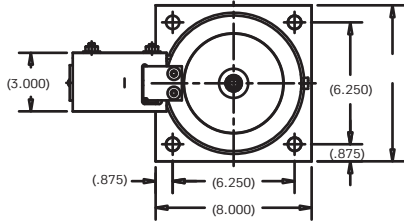

THYSSEN KRUPP PART NO.	DIM "A"	DIM "B"	DIM "C"	DIM "D"	MAX. LOAD RATING (lbs)	MIN. LOAD RATING (lbs)	MAX. RATED STRIKE SPEED (FPM)	BUFFER STROKE
6002AB1	27.500	22.500	12.750	11.750	11000	1425	288	5.00
6002AB2	31.000	22.500	12.750	11.750	11000	1425	402	8.50
6002AB3	34.500	23.500	15.250	14.250	11000	1425	460	11.00
6002AB4	49.250	32.250	21.250	20.250	11000	1425	575	17.00
6002AB6	88.750	55.500	37.500	36.500	11000	1425	805	33.25
6002AB7	114.500	70.750	48.000	47.000	11000	1425	920	43.75
6002AB8	174.750	106.250	72.750	71.750	7000	1900	1150	68.50

Buffer Ordering Information

Company Name _____ Date _____ By _____

Job Name _____ Job Number _____

Qty.

Buffer Part No.

- Switch Required
- Switch Required
- Switch Required